

ACEST DOCUMENT ESTE PROPRIETATEA SOCIETATII ELLIS'92 S.R.L.-PLOESTI. IN CONSECINTA, FIRMA ARE DREPTUL  
EXCLUSIV DE FOLOSIRE A DESENULUI SAU DE OPERARE A EVENTUALELOR MODIFICARI DIN CAMPIUL ACESTUIA.

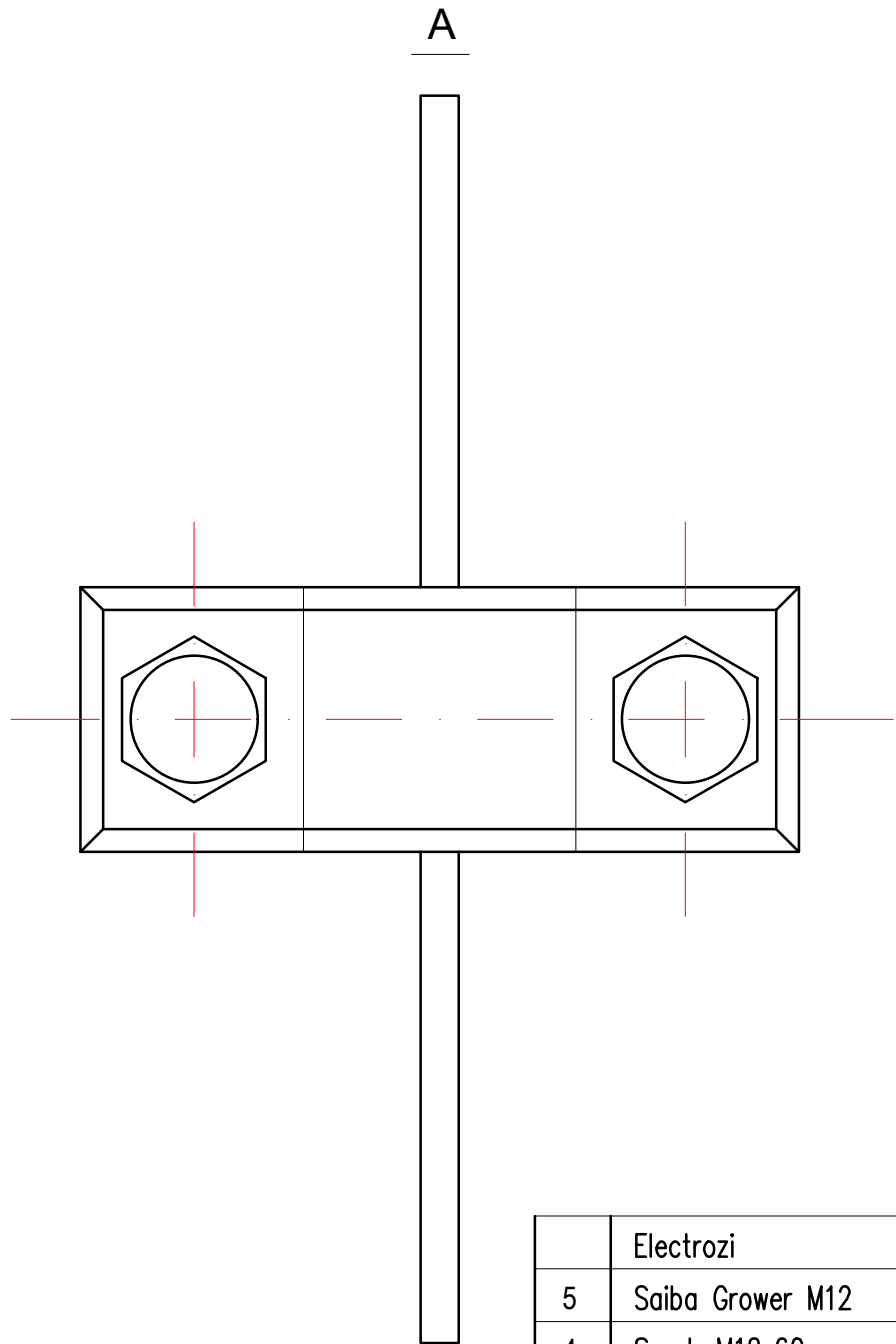
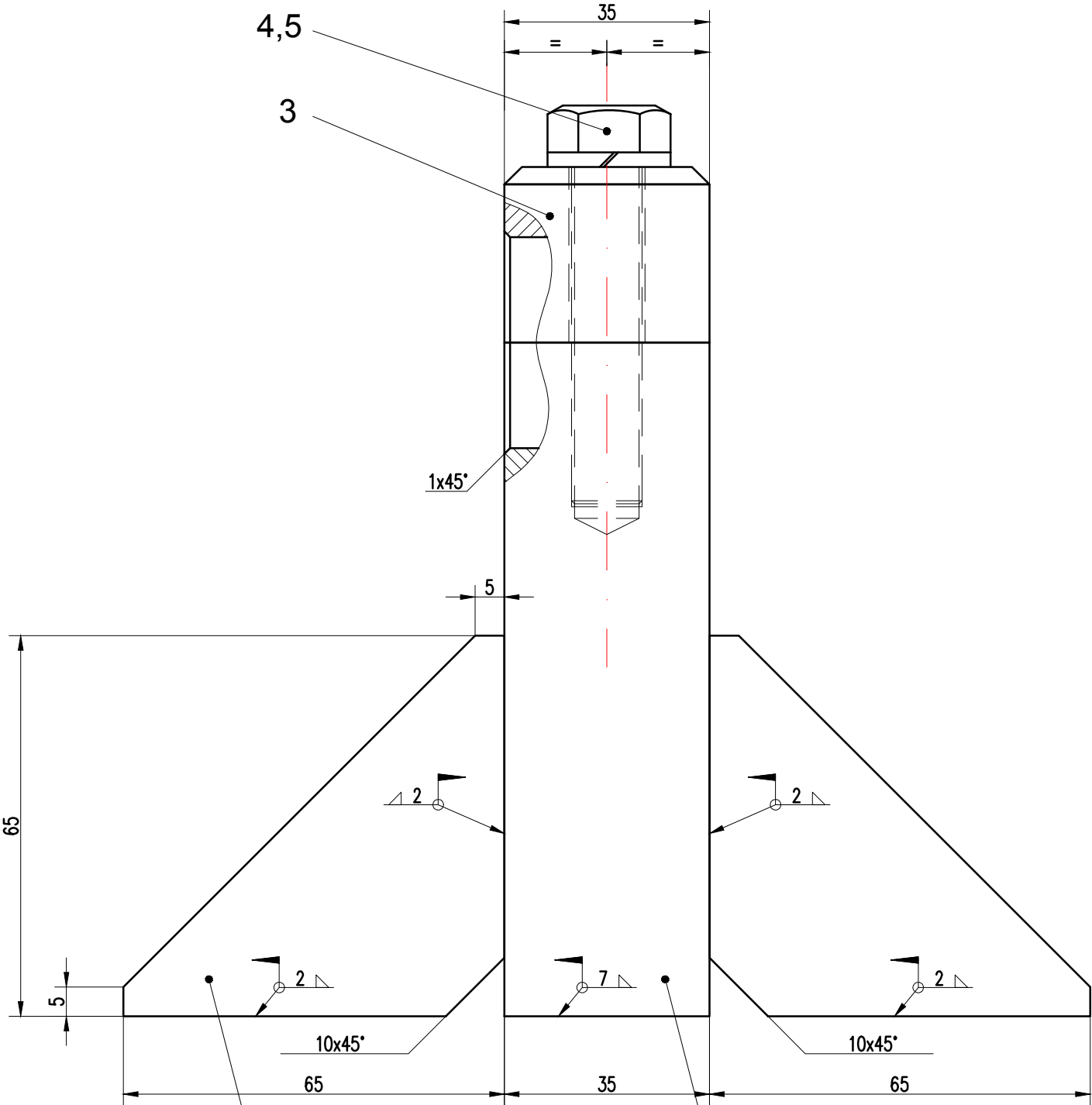
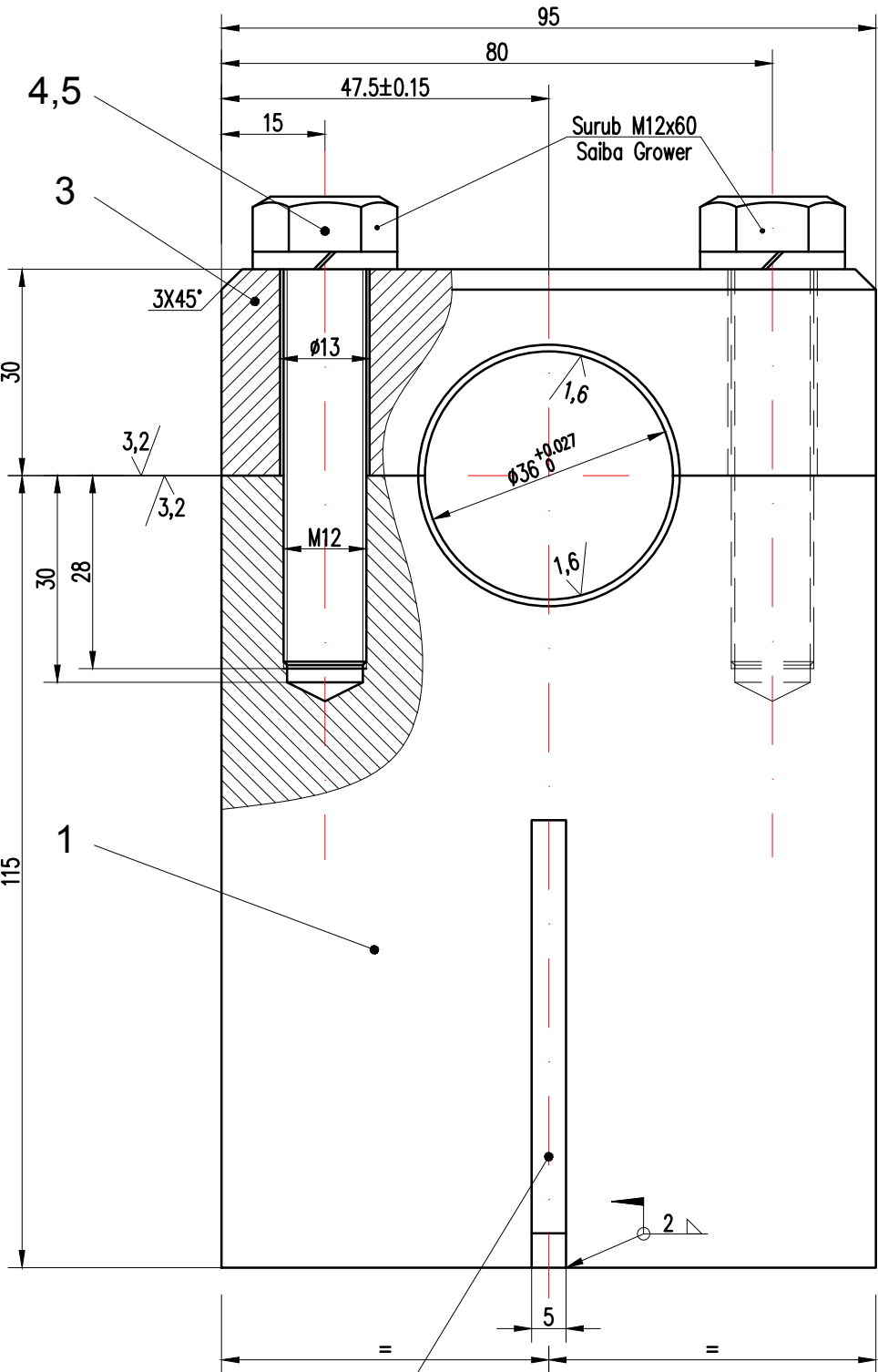

	Electrozi					0.30
5	Saiba Grower M12	STAS 7666/2-80	2			0.003
4	Surub M12x60	SR EN ISO 4018	2	gr. 8.8		0.07
3	Lagar superior		1	S275JR		0.60
2	Nervura		2	S235JR		0.08
1	Lagar inferior		1	S275JR		2.80
Poz.	Denumirea	Nr. desen sau STAS	Buc.	Material	Obs.	Masa neta kg/buc

3			6			
2			5			
1			4			

Rev.	Descriere	Data	Semnat	Rev.	Descriere	Data	Semnat
------	-----------	------	--------	------	-----------	------	--------

Acest document este proprietatea S.C. ELLIS'92 S.R.L. si nu va fi comunicat fara autorizare

Intocmit	Verificat	Aprobat	Beneficiar	Denumire proiect
Mircea Parvulescu	Razvan Nita	Androne Ionescu	CONPET S.A.	REABILITARE RAMPA DE INCARCARE TITEI MARGHITA, JUD. BIHOR

	COLECTOR DE SLOPS ROATA MANEVRA LAGAR 1		Nr.: A636.4-DT-05.04.01
			Scara: 1:1
	Material: Masa: 4.00 kg		Index: A636.4-DT-BD REV.0
		Data: 06.2018	Plansa: 1/1

1.5 A3 (630x297)